

17.Front Hood Lock Assembly

A: REMOVAL

- 1) Open the front hood.
- 2) Remove the clip, and remove the bracket - grille.

NOTE:

To prevent damage to the bracket - grille, make sure to remove all clips.

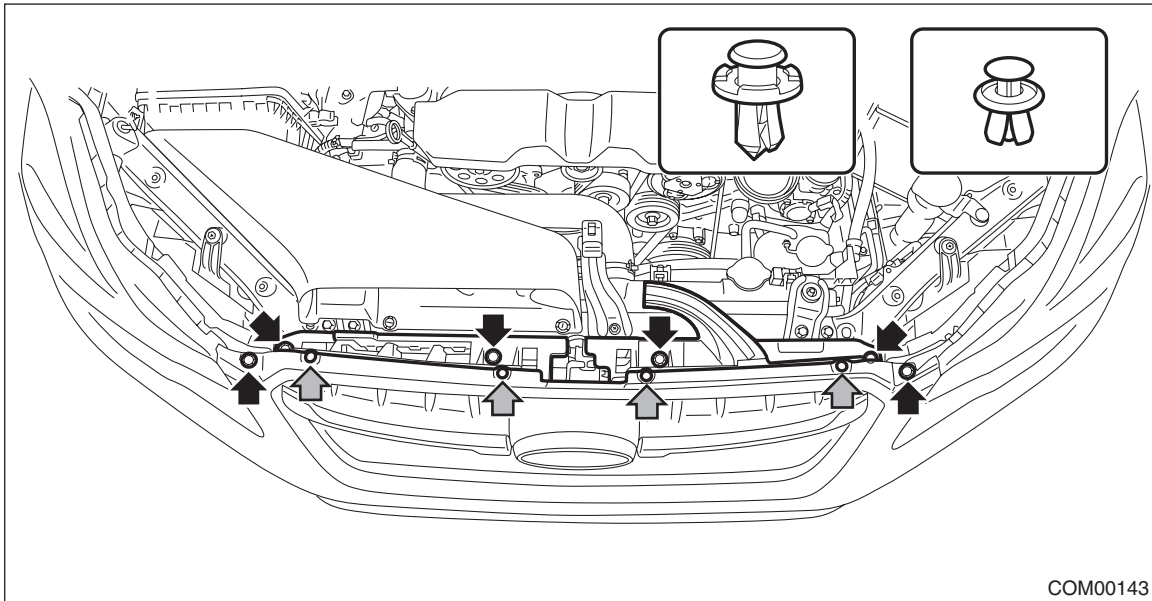

- 3) Remove the lock assembly - front hood.
 - (1) Remove the bolt and clip.

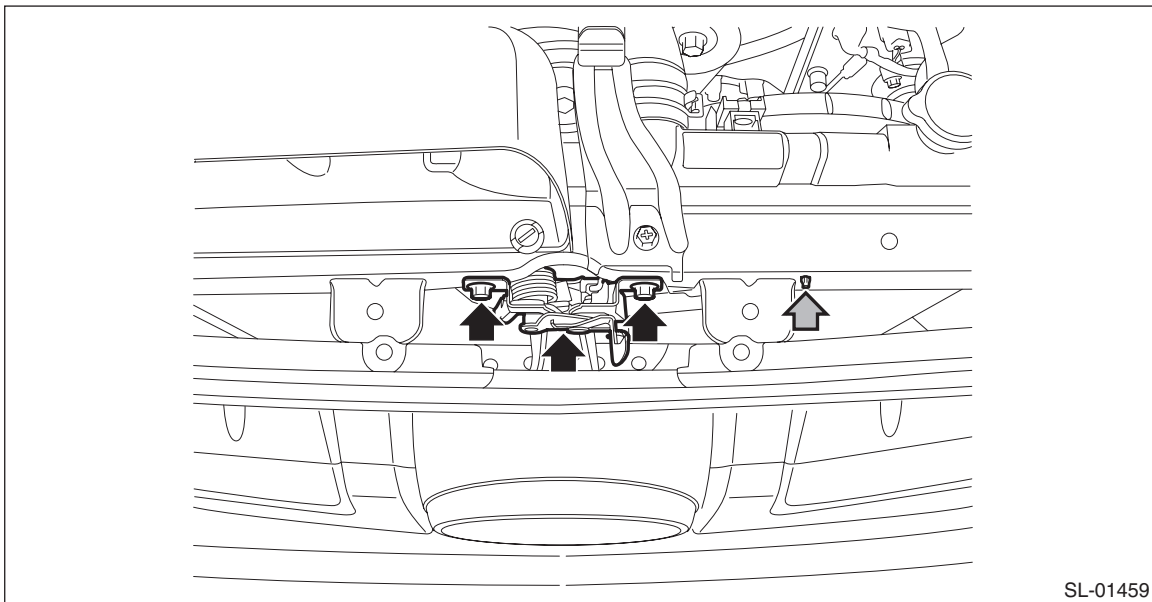

- (2) Disconnect the release cable, and detach the lock assembly - front hood.

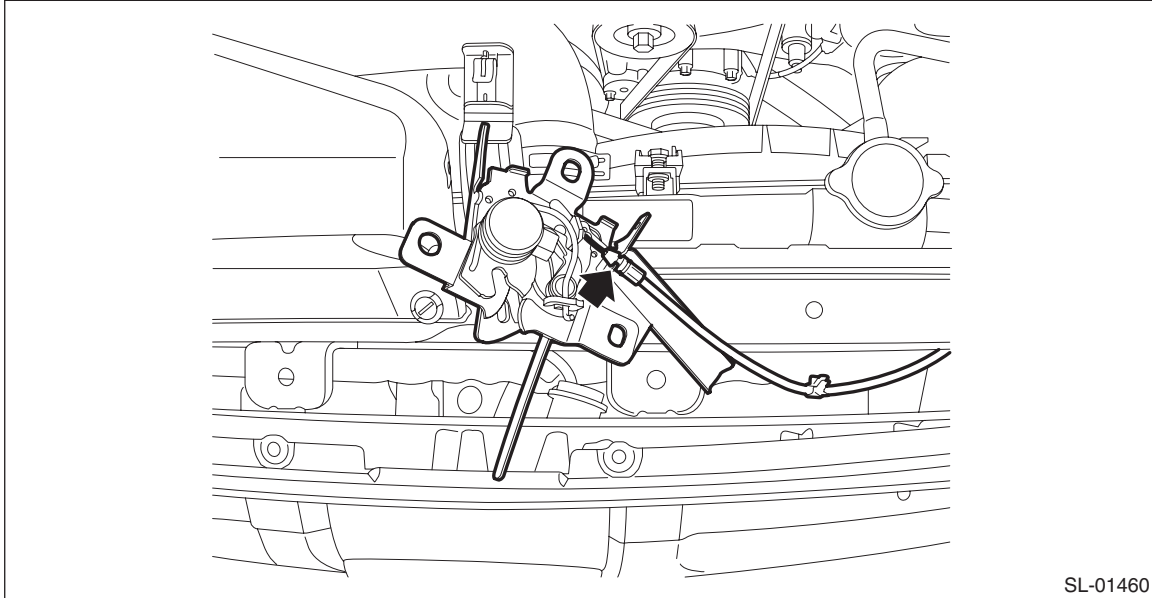

SL-01460

NOTE:

When disconnecting the release cable, refer to “FRONT HOOD OPENER” of “Remote Openers”. <Ref. to SL-63, FRONT HOOD OPENER, REMOVAL, Remote Openers.>

B: INSTALLATION

- 1) Before installation, check the following items.

- Is the cable deformed?
- Grease is applied sufficiently to cable joints.

If grease is insufficient, add it as necessary before assembling the cable.

- 2) Install each part in the reverse order of removal.

Tightening torque:

Refer to “COMPONENT” of “General Description”. <Ref. to SL-4, FRONT HOOD LOCK, COMPONENT, General Description.>

Front Hood Lock Assembly

SECURITY AND LOCKS

C: ADJUSTMENT

1) Loosen the bolt, and adjust the lock assembly - front hood while moving it up and down.

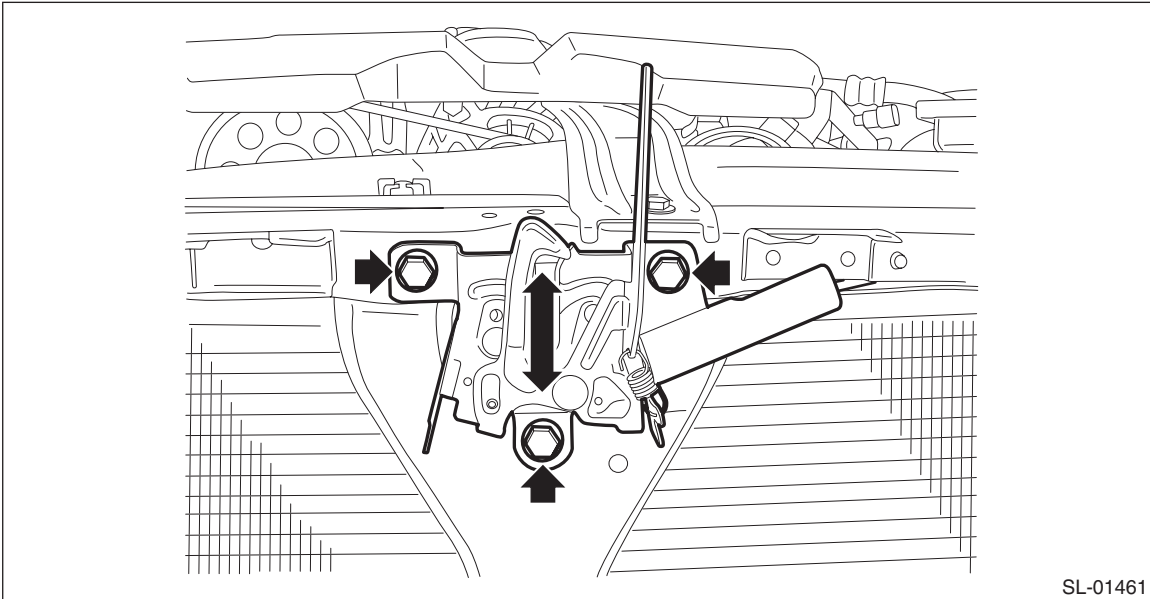

2) After adjustment, tighten the bolts securely.

Tightening torque:

Refer to “COMPONENT” of “General Description”. <Ref. to SL-4, FRONT HOOD LOCK, COMPONENT, General Description.>

D: INSPECTION

Check if the lock assembly operates normally.

If lever deformation, abnormal wear, or unsmooth lock operation is observed, replace the lock assembly - front hood.